

Head Office:
Dixon Kelley Estate Agents
1 Penn Court
Station Road, West Moors
Dorset. BH22 0JJ

DORSET PARK HOMES

DRAFT

www.dorsetparkhomes.com

Telephone: 01202 877511

51 Pinehurst Park, West Moors, Ferndown, BH22 0BP

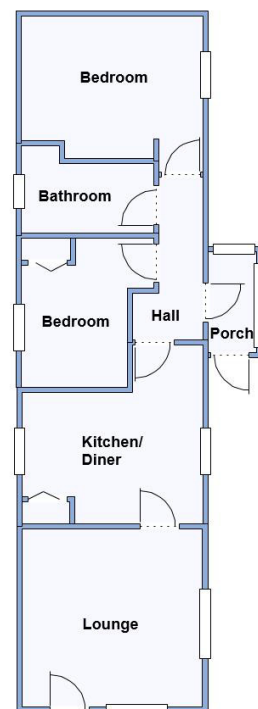

This drawing has been prepared for diagrammatic purpose only. Not to scale

2 Bedroom Park Home approx 44' x 12'

Accommodation & approximate room dimensions:

- Wonderland Park Home circa 1993
- Enclosed Entrance Porch
- Hall
- Kitchen/Diner approx 11'5" x 11'7" max. Range of floor and wall cupboards. Space for cooker, tall fridge/freezer & plumbing for washing machine. Cupboard housing combination gas boiler.
- Lounge: approx 11'7" x 11'5". Feature fireplace.
- Bedroom 1: approx 11'7" x 9'1".
- Bedroom 2: approx 9'6" x 7'1". Double wardrobe .
- Bathroom: Modern suite comprising panelled bath with thermostatic shower over. Vanity wash basin & WC. Chrome heated towel rail.
- Gas Central Heating (system untested)
- PVCu Double-Glazing
- Parking on Plot
- Delightful Patio Garden with Shed & Greenhouse
- Age Restriction 45+ Pets Considered
- Popular, well maintained Residential Park near to local amenities, bus services and protected nature walks.

Popular 'Pet Friendly' Park



Pitch Fee: approx £224.97 per month including water
Subject to Annual Review
Council Tax Band: 'A' Tenure: 1983 Mobile Homes Act Agreement

Price £99,950

VIEWING STRICTLY BY APPOINTMENT WITH THE VENDOR'S AGENT Dorset Park Homes 01202 877511

IMPORTANT NOTE: These particulars are believed to be correct but their accuracy is not guaranteed. They do not form part of any contract. Nothing in these particulars shall be deemed to be a statement that the property is in good structural condition or otherwise, nor that any of the services, appliances, equipment or facilities are in good working order or have been tested. Purchasers should satisfy themselves on such matters prior to purchase Ref.W04702

The recommended specialist in Park Home sales
Proprietor: Simon Dixon

